

Lots 110 THRU 119  
 & 216 & 217  
 TO CITY OF N.P.B.  
 PER OR 2772-1189

NOTE: SANDERS ADD (S) EXCLUDED INSEL 4

NOTE: (04)  
 COUNCIL EST. VS CODED IN ERG 4

**Palm Beach County (County) makes no representation or warranties whatsoever on the attached / enclosed information reflected herein pertaining to easements, rights-of-way, setback lines, reservations, agreements, and other similar matters. The information provided herein should not be relied upon by the requesting party to confirm the existence / non-existence of facts contained herein.**

- NW 01 SHEPLEY ESTS (74) PB 24- 96
  - " 02 COUNTRY CLUB PARK " PB 23- 215
  - NW 03 " " NO 2 " PB 23- 241
  - NE 04 HILLSIDE PARK " PB 12- 11
  - NE 05 FOREST RIDGE PARK " PB 11- 58
  - SE 06 WOODLAWN WPB " PB 10- 41
  - SE 07 MARIAN PARK WPB " PB 4- 52
  - SW 08 MARIMONT WPB (74) PB 14- 57
  - NW 09 HILLCREST MEMORIAL PARK (74) PB 16- 50
  - " " " " " PB 22- 33
  - " " " " " PB 24- 119
- NOTE: SEE 74-43-44-04-00-008-0160-ALL COMBD/W, BUT NOT DELETED

**FOREST HILL BLVD.**  
 B.C.C INDICATED AGREEMENT WITH TRANSFER OF JURISDICTION & CLASSIFICATION OF FOREST HILL BLVD. FROM STATE TO COUNTY (CONGRESS AV. TO U.S.1) RES. 87-1594

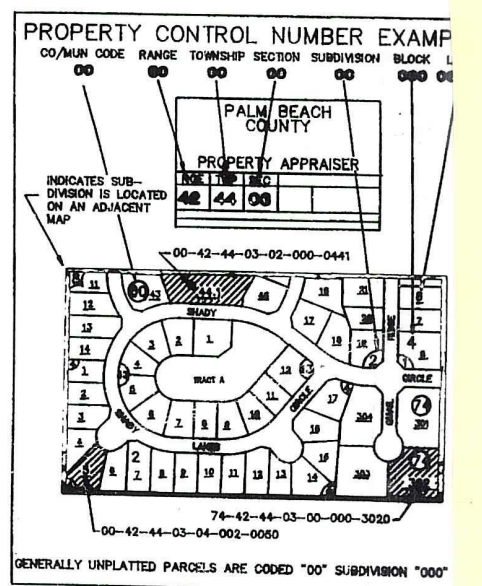

16-44-43  
 9-44-43

**PALM BEACH COUNTY**  
**GARY R. NIKOLITS**

PROPERTY CONTROL NUMBER EXAM			
RGE	TWP	SEC	AERIAL
43	44	9	NO 1151
SCALE 1" = 200'			
DRAWN BY			
UPDATED 2/13/2023			

