

NW 01 EXECUTIVE CENTER PARK PB28-PG229
 E 1/2 02 BREAKWATER OF THE PALM BEACHES COND.
 SE 03 EDEN PLACE COND (1984) PH 7&8, 25
 NW 04 EXECUTIVE CENTER PLAZA COND (1955)
 SE 05 LAKE PLACE COND PH 1 (1931)

Palm Beach County (County) makes no representation or warranties whatsoever on the attached / enclosed information reflected herein pertaining to easements, rights-of-way, setback lines, reservations, agreements, and other similar matters. The information provided herein should not be relied upon by the requesting party to confirm the existence / non-existence of facts contained herein.

NOTE:
 ALL OF SEC. 20

NOTE:
 NOT TO BE REPRODUCED IN ANY FORM EXCEPT BY EXPRESS WRITTEN CONSENT FROM THE PALM BEACH COUNTY PROPERTY APPRAISER
 Information shown hereon is compiled from the best available sources and CANNOT be used for surveys or land transfers of any type.

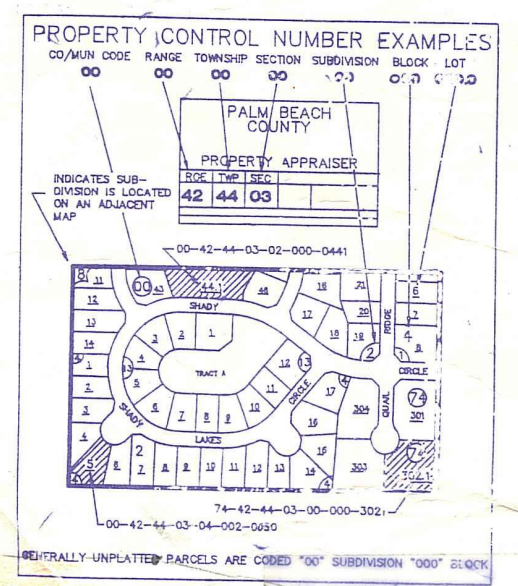

PALM BEACH COUNTY
GARY R. NIKOLITS
 PROPERTY APPRAISER

36	31	32	33	34	35	36	37
1	8	5	4	3	2	1	6
12	7	6	9	10	11	12	7
13	18	17	16	15	14	13	18
24	19	20	21	22	23	24	19
25	20	29	28	27	26	25	30
36	31	32	33	34	35	36	37
31	17	4	3	2	1	6	

RGE	TWP	SEC	AERIAL
43	43	20	NO 87-57
SCALE	1" = 200'		
DRAWN BY	ED. KESHIAN 1-20-77		
UPDATED			

D-18