

**Palm Beach County (County) makes no representation or warranties whatsoever on the attached / enclosed information reflected herein pertaining to easements, rights-of-way, setback lines, reservations, agreements, and other similar matters. The information provided herein should not be relied upon by the requesting party to confirm the existence / non-existence of facts contained herein.**

- 421 NW 01 CENTRAL IND PARK PB 30 P37
- 422 SW 02 BLUE HERON GARDENS (1977) PB 51 P228
- 423 SW 03 FLORIDA - GEORGIA (1978) PB 32 P149
- 424 SW 04 NATIONAL VILLAGE PL 1 PB 33 P122 (1977)
- 425 SW 05 NATIONAL VILLAGE PL 2 (1978) PB 34 P108
- 426 SW 06 CENTRAL INDUSTRIAL PARK (1978) PB 35 P151
- 427 NW 07 ADD 2 CENTRAL INDUSTRIAL PARK (1980) PB 37 P167
- 428 NW 08 KOCH ADD TO PLAT 1 OF CENTRAL INDUSTRIAL PARK (1980) PB 37 P165
- 429 SW 09 MARTINO PLAT 1 (1980) PB 38 P 84
- 430 SW 10 HUNT'S EASY STORAGE PL 3 (1981)
- 431 SW 11 MARTINO PLAT NO 2 (1982) PB 39 P81
- 432 SW 12 AMOCO OIL PL NO. 1 (1983) PB 42 P125
- 433 SW 13 HUNT CLEMENT REPL (83) PB 47 P104
- 434 NW 14 CENTRAL INDUSTRY PARK PL 2 (86) PB 51 P102
- 435 SE 15 TIMBER PINE NORTH PL 1 (87) PB 51 P119
- 436 SE 16 CONGRESS PARK (87) PB 52 P197
- 437 SE 17 WEDGEWOOD PLAZA (88) PB 56 P72
- 438 SW 18 MARTINO PL 3 (89) PB 59 P4
- 439 SE 19 TIMBER PINE NORTH PL 2 (89) PB 59 P38
- 440 SE 20 WEDGEWOOD CENTRE (89) PB 60 P168
- 441 SE 21 CONGRESS PARK REPL (90) PB 62 P77
- 442 SW 22 MARTINO PL 4 (91) PB 67 P8

- Notes:**
- (Blue Heron Blvd) between U.S. #1 & I-95, maintained by P.B. Co. as per R 92-1366 - E.R. 90-793 TO TRANSFER TO STATE
  - (Blue Heron Blvd) between U.S. #1 & West City Limits of Riviera Sch. maintained by P.B. Co. as per R 92-800 (see Time Note)
  - (Garden Rd) between Blue Heron Blvd. & Port Rd. maintained by P.B. Co. as per R 92-800.
  - (Congress Ave.) between Blue Heron Blvd. & Port Rd. maintained by P.B. Co. as per R 92-724.
  - (Congress Ave.) within Riviera Sch. City Limits maintained by P.B. Co. as per R 92-800.
  - (Silver Beach Rd) maintained by P.B. Co. as per R 92-1700 D. FROM AV 15 TO CONGRESS AV.

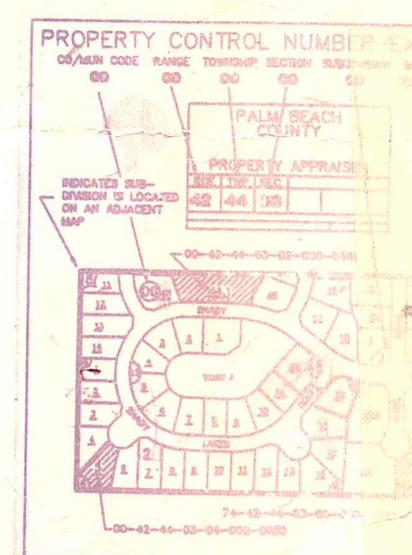

30-42-43  
TO  
33-42-43

36	31	32	33	34	35
1	6	9	2	3	4
12	7	8	10	11	5
13	17	16	15	14	13
24	19	20	21	22	23
25	20	21	22	23	24
26	21	22	23	24	25
27	22	23	24	25	26
28	23	24	25	26	27
29	24	25	26	27	28
30	25	26	27	28	29
31	26	27	28	29	30
32	27	28	29	30	31
33	28	29	30	31	32
34	29	30	31	32	33
35	30	31	32	33	34
36	31	32	33	34	35