

Palm Beach County (County) makes no representation or warranties whatsoever on the attached / enclosed information reflected herein pertaining to easements, rights-of-way, setback lines, reservations, agreements, and other similar matters. The information provided herein should not be relied upon by the requesting party to confirm the existence / non-existence of facts contained herein.

FOR ROAD R/W ABANDONMENT WITHIN THIS SECTION - SEE R 74-565

30' CH DEL MAR N 4 TR 1124
FIRE CONTROL BY ORDINANCE 0783-23 (SEE MISCELLANEOUS)

Drainage EMENTS B 3720-762 THRU 767 IN S 1/4 OF E 1/2 OF S 1/4 TRACT 35 EXHIBITS: B-C-D-E

NOTE:
NOT TO BE REPRODUCED IN ANY FORM EXCEPT BY EXPRESS WRITTEN CONSENT FROM THE PALM BEACH COUNTY TAX ASSESSOR.
Information shown hereon is compiled from the best available sources and CANNOT be used for surveys or land transfers of any type.

40' D.E. ABANDONED BY RES. R 82-399 (ALLEN'S)

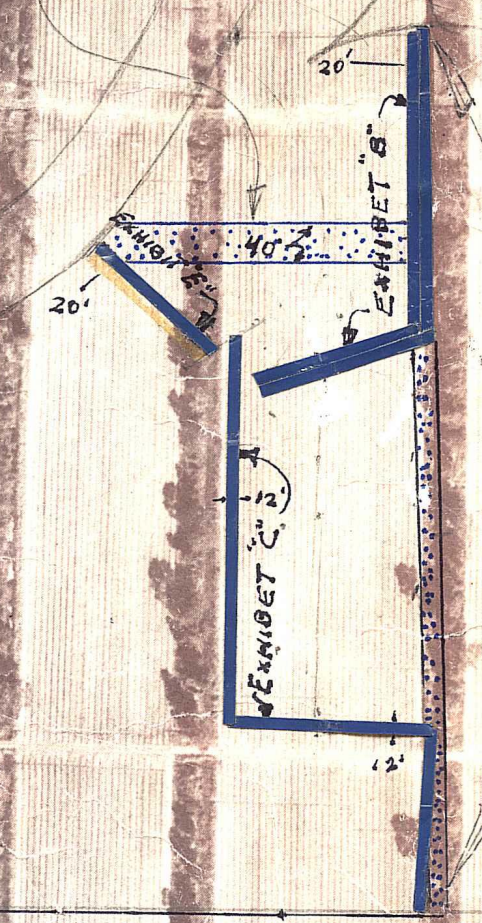

40' D.E. ABANDONED BY RES. R 82-399 (ALLEN'S)

BOCA DEL MAR TR 35 PB 30 85