

304
10.00 AC.

301
15.73 AC

307
72.5 AC

318
10.94 AC

309
9.62 AC.

308
5.51 AC

717
14.56 AC

714
14.56 AC

704
15.91 AC

706
5.0 AC.

723
1.31 AC

722
1.31 AC

701
2.5 AC.

715.1
3.47 AC

720
10.00 AC.

715
3.47 AC

716
3.47 AC

510
11.38 AC

502
11.38 AC

509
142 AC.

LAKE PARK RD. AKA NORTHLAKE BLVD.

Notes:

- military trail (100') to state by OR 1544-1 (1967)
- military trail transferred to P.B. Co. from state by agreement, R87-1592. Between
- Bee line & PGA Blvd: For CLASSIFICATION AND JURISDICTION; & reconveyed to STATE AS LETTER DATED 08/01/1984 (SEE UNRECORDED FILE) (LETTER R85-1079 changes Lake Park Rd. to Northlake Blvd. to Northlake Blvd. by D. 913-412 & D. 912-412)
- NORTHLAKE BLVD SE 1/4 AC. by D. 913-412 & D. 912-412

Palm Beach County (County) makes no representation or warranties whatsoever on the attached / enclosed information reflected herein pertaining to easements, rights-of-way, setback lines, reservations, agreements, and other similar matters. The information provided herein should not be relied upon by the requesting party to confirm the existence / non-existence of facts contained herein.

- SW01 PALM BEACH SQUARE UNIT 1 PB 26-143
- SW02 " " " " 2 PB 26-232
- SW03 " " " " 3 PB 26-233
- SW04 " " " " 4 PB 27-15
- SW05 " " " " 5 PB 27-45
- SW06 " " " " 6 PB 27-149
- SW07 HIGHLAND PINES (1978) PB32P109
- SW08 GARDENS PARK (1979) PB35P32
- SW09 KING ARTHUR ESTATES (1979) PB35P46
- SW10 HIGHLAND PINES PL.2 (1979) PB35P107
- SW11 PINE CONE ESTATES (1979) PB36P25
- SW12 KING ARTHUR ESTATES REPL OF LTS 22 & 23 (8) PB 36P197
- SW13 GARDENS GLEN (1981) PB 40P146
- SW14 GREEN MEADOWS (1981) PB 41P102

NOTE:
FT OF SEC CODED IN

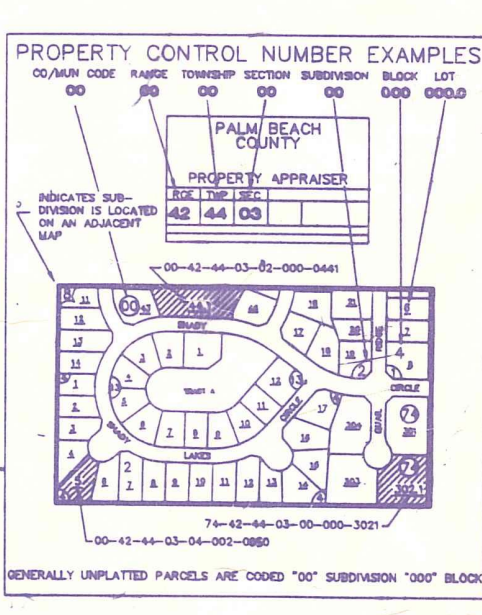

NOTE:
NOT TO BE REPRODUCED IN ANY FORM EXCEPT BY EXPRESS WRITTEN CONSENT FROM THE PALM BEACH COUNTY PROPERTY APPRAISER
Information shown hereon is compiled from the best available sources and CANNOT be used for surveys or land transfers of any type.

PALM BEACH COUNTY
N-11
PROPERTY APPRAISER

| | | | | | | | |
|----|----|----|----|----|----|----|----|
| 38 | 31 | 32 | 33 | 34 | 35 | 36 | 37 |
| 1 | 8 | 4 | 3 | 2 | 1 | 6 | |
| 12 | 7 | 5 | 9 | 10 | 11 | 12 | 7 |
| 13 | 18 | 17 | 16 | 15 | 14 | 13 | 18 |
| 24 | 19 | 20 | 21 | 22 | 23 | 24 | 19 |
| 25 | 30 | 29 | 28 | 27 | 26 | 25 | 30 |
| 36 | 31 | 32 | 33 | 34 | 35 | 36 | 31 |
| 1 | 8 | 4 | 3 | 2 | 1 | 6 | |

RGE TWP SEC AERIAL -
42 42 13 NO
SCALE 1" = 200'
DRAWN BY
UPDATED

F-11