

**Palm Beach County (County) makes no representation or warrants whatsoever on the attached / enclosed information reflected herein pertaining to easements, rights-of-way, setback lines, reservations, agreements, and other similar matters. The information provided herein should not be relied upon by the requesting party to confirm the existence / non-existence of facts contained herein.**

- 01 PALM BEACH GARDENS CITY OF NO.6 PB27-130
- 02 PGA NATIONAL GOLF CLUB ESTS.NO.1 PB 27-206
- 03 GOLFERS VILLAGE OF P.B. GARDENS PB 28-83
- 04 PGA NATIONAL GOLF CLUB ESTS. PL.2 PB.28-72
- 05 MANSON CONDO. NO.1 PB 28-83.
- 06 " " " 2
- 07 " " " 3
- 08 TRAILS END VILLAS CONDO
- 09 PALM GARDEN APT CONDO
- 10 VISION ONE PB 35 PGS 60-61 (1979)
- 11 GARDEN VILLAS TWNHS PB 38 P27 (80)
- 12 GEORGIAN MEWS CO F047 P122 18ND (8)
- 13 CLOCKTOWER PROFESSIONAL CONDO (88)
- 14 ELMARC TWH AKA LILAC ST TWH OR2544 P1293
- 15 PINEHURST GARDENS OR2804 P1794
- 16 GARDENS TRAIL PB62P52 (90)
- 17 GOLF ESTATE VILLAS PB63P12 (90)
- 18 SOUTH PARK CENTER (9) PB67P67 (9)
- 19 NORTHCORP CENTER PB67P93 (9)

**Notes:**

- military trail by R87-1592, transferred from state to P.B. Co. between PGA Blvd. & S.R. 710 (Boebling Hwy.)
- military tr: RECOVERED TO STATE SAME AREA AS LETTER DATED AUGUST 16, 1994; JURISDICTIONAL TRANSFER OF RESPONSIBILITY: (SEE UNRECORDED SEE ALSO LETTER DATED 1-7-97 FILE)
- No Commission Meeting on 9-20-27

ALL OF SEC. IN CITY LIMITS (52)

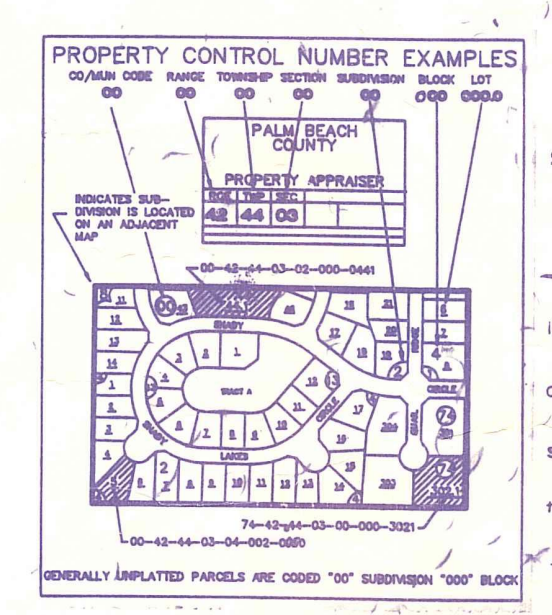

**PALM BEACH COUNTY**  
N-11  
PROPERTY APPRAISER

36	31	32	33	34	35	36	31	FILE	TWP	SECT	
1	4	5	4	3	2	1	8	42	42	12	737
13	7	8	9	10	11	12	7			1/2 200	
24	19	20	21	22	23	24	13			KEB	8-73
25	20	21	22	23	24	25	13				
26	31	32	33	34	35	36	31				
1	0	0	0	0	0	0	0				