

Palm Beach County (County) makes no representation or warranties whatsoever on the attached / enclosed information reflected herein pertaining to easements, rights-of-way, setback lines, reservations, agreements, and other similar matters. The information provided herein should not be relied upon by the requesting party to confirm the existence / non-existence of facts contained herein.

Notes:
Centerline of Hood Road is not drawn to scale. According to DB 1083-141 the 'C' is 1575.40' South of NE corner & 1413.94' South of NW corner.

NOTE:
PT OF SEC IN COUNTY 00
" " " " P.B. GARDENS 52

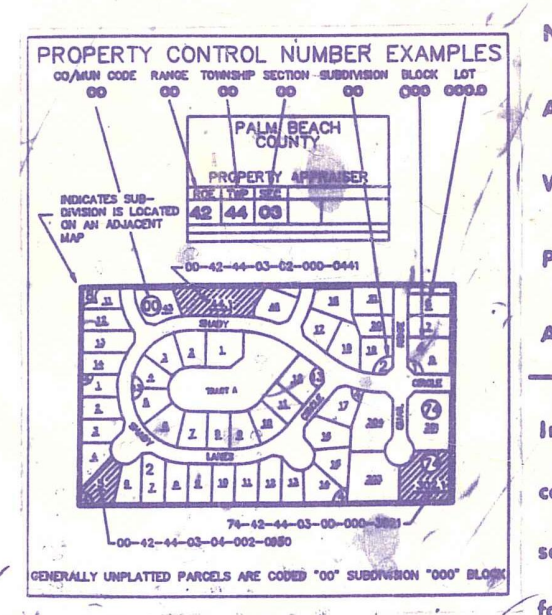

NOTE:
NOT TO BE REPRODUCED IN ANY FORM EXCEPT BY EXPRESS WRITTEN CONSENT FROM THE PALM BEACH COUNTY ASSESSOR.
Information shown hereon is compiled from the best available sources and CANNOT be used for surveys or land transfers of any type.

PALM BEACH COUNTY
N-9
PROPERTY APPRAISER

36	31	32	33	34	35	36	31	RGE	TWP	SEC	AERIAL
1	8	5	4	3	2	1	8	42	41	36	NO 739
12	11	10	9	8	7	6	12	SCALE	1"=200'		
13	18	17	16	15	14	13	18	DRAWN BY	Jana Bickel / 1/2/09		
24	19	20	21	22	23	24	19	UPDATED	2-28-09		
25	30	29	28	27	26	25	30				
36	31	32	33	34	35	36	31				
1	2	3	4	5	6	7	1				