

Palm Beach County (County) makes no representation or warranties whatsoever on the attached / enclosed information reflected herein pertaining to easements, rights-of-way, setback lines, reservations, agreements, and other similar matters. The information provided herein should not be relied upon by the requesting party to confirm the existence / non-existence of facts contained herein.

- NE 01 JUPITER VILLAGE PH I (1980) PB 38 P25
- NE 02 JUPITER VILLAGE PH II (1980) TM 81-32 PB 39 P 182
- NE 03 JUPITER VILLAGE PH III (1980) TM 81-33 PB 40 P 103
- NE 04 JUPITER VILLAGE PH IV (1982) PB 41 P 38
- NE 05 JUPITER VILLAGE PH V (1982) PB 42 P 167
- SE 06 INDIAN CREEK PH I (1982) PB 43 P 43
- SE 07 INDIAN CREEK PH II - A (1982) PB 43 P 21
- SE 08 INDIAN CREEK PH III - B (1982) PB 43 P 22
- NE 09 JUPITER VILLAGE PH VI (1982) PB 44 P 80
- NE 10 JUPITER VILLAGE PH VII (1984) PB 44 P 82
- NE 11 JUPITER VILLAGE TOWNHOMES CONDO (1984) PB 45 P 50
- NE 12 JUPITER VILLAGE PH VIII - A (1984) PB 45 P 50
- NE 13 JUPITER VILLAGE PH IX (1984) PB 45 P 102
- NE 14 JUPITER VILLAGE PH X (1984) PB 45 P 118
- SE 15 INDIAN CREEK PH I (1984) PB 46 P 84
- NE 16 JUPITER VILLAGE TOWNHOMES CONDO PH 8 (1984) PB 46 P 84
- SE 17 INDIAN CREEK PH X (85) PB 46 P 10
- NOTE: LYS EXTEND TO E OF RD
- SW 19 INDIAN CREEK PHASE II (1985) PB 49 P 13
- SW 19 INDIAN CREEK PHASE IV - A (1985) PB 49 P 15
- SW 20 INDIAN CREEK PHASE IV - B (1985) PB 49 P 18
- NOTE: LOTS & TOWNS
- SW 21 WINGFOOT COND (1985) (187) (88)
- SE 22 INDIAN CREEK PHASE 10 (1985) PB 51 P 9
- SW 23 INDIAN CREEK PH C (89) PB 55 P 58
- SW 24 INDIAN CREEK PH 4A REPL (89) PB 55 P 82
- SE 25 INDIAN CREEK PH 10 REPL (89) PB 56 P 23
- SW 26 PINE CREST COND (88)
- SW 27 INDIAN CREEK PH 8 - A (89) PB 59 P 54
- SW 28 INDIAN CREEK PH 7 (89) PB 60 P 104
- SW 29 INDIAN CREEK PH 8 B (89) PB 61 P 30
- SW 30 KEYSTONE COND (89) (90) & (91)
- SW 31 INDIAN CREEK PH 11 (91) PB 65 P 30
- SW 32 INDIAN CREEK DRIVE WEST (91) PB 66 P 30
- SW 33 MUIRFIELD COND (91) (92)

NOTE: CENTRAL BLVD (1) MAINTAINED BY PDC WITHIN TOWN OF JUPITER BY RES. 72-800 (RES. FILE)

(2) MAINTAINED BY PDC FROM 615' NORTH OF INDIAN CREEK DR. NORTH TO 930' SOUTH OF INDIAN CREEK DR. EASE. RES. 96-848

(3) FOR TRAFFIC CONTROL JURISDICTION & MAINTENANCE WITHIN 35' TIES WITH COUNTY SEE R. 78-1952-D NOT TO BE REPRODUCED IN ANY FORM EXCEPT BY EXPRESS WRITTEN CONSENT FROM THE PALM BEACH COUNTY ASSESSOR.

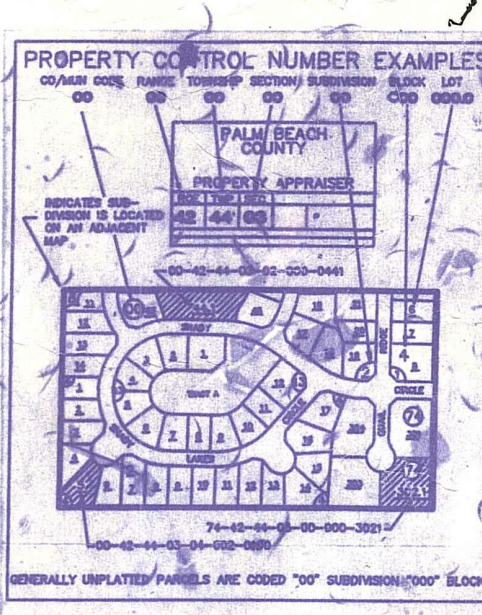

PALM BEACH COUNTY
N-7
PROPERTY APPRAISER

AGE	TWP	SEC.	AERIAL
42	41	10	NO 1126
SCALE: 1" = 200'			
DRAWN BY: Jow Burke			
UPDATED: 03-25-92			

I-95 R/W OR4228 P0584

I-95 R/W 03 ac