

01 PADDOCK PARK NO2 OF WELLINGTON (198) PB4I P99
 NE 02 SUGAR POND MANOR PARCEL ONE OF TRACT A PB 45P52 (1984)
 03 WOODS OF WELLINGTON I-COND TERMINATED 01/27/77 PG679
 NE 04 WELLINGTON MARKETPLACE PL (92) PB69P3

Palm Beach County (County) makes no representation or warranties whatsoever on the attached / enclosed information reflected herein pertaining to easements, rights-of-way, setback lines, reservations, agreements, and other similar matters. The information provided herein should not be relied upon by the requesting party to confirm the existence / non-existence of facts contained herein.

ROADS REMOVED FROM RD MAINTENANCE INVENTORY AS RESULT OF WELLINGTON INCORPORATION ON NOV. 7, 1995

NOTE: SUGAR POND MANOR OF WELLINGTON CODED 41-44-04-01

NOTE ALL OF SECTION COUNTY

NOTE: NOT TO BE REPRODUCED IN ANY FORM EXCEPT BY EXPRESS WRITTEN CONSENT FROM THE PALM BEACH COUNTY ASSESSOR.

Information shown hereon is compiled from the best available sources and CANNOT be used for surveys or land transfers of any type.

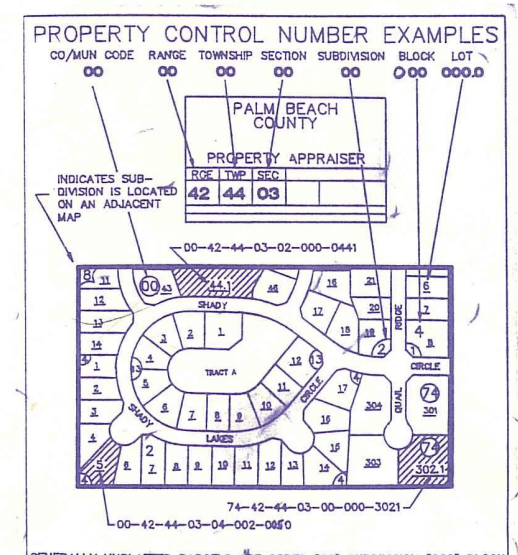

PALM BEACH COUNTY
GARY R. NIKOLITS
 PROPERTY APPRAISER

36	31	32	33	34	35	36	37
1	6	5	4	3	2	1	6
2	7	8	9	10	11	12	7
13	18	17	16	15	14	13	18
24	19	20	21	22	23	24	19
25	30	29	28	27	26	25	30
36	31	32	33	34	35	36	31
1	6	5	4	3	2	1	6

SCALE 1:200
 DRAWN BY
 UPDATED

