

SI OF SADDLE TRAIL PARK OF WELLINGTON (1981) PB 41 P103

Palm Beach County (County) makes no representation or warrants whatsoever on the attached / enclosed information reflected herein pertaining to easements, rights-of-way, setback lines, reservations, agreements, and other similar matters. The information provided herein should not be relied upon by the requesting party to confirm the existence / non-existence of facts contained herein.

ROADS REMOVED FROM RD MAINTENANCE INVENTORY AS RESULT OF WELLINGTON INCORPORATION ON NOV. 7, 1995

NOTE:
NOT TO BE REPRODUCED IN ANY FORM EXCEPT BY EXPRESS WRITTEN CONSENT FROM THE PALM BEACH COUNTY ASSESSOR.
Information shown hereon is compiled from the best available sources and CANNOT be used for surveys or land transfers of any type.

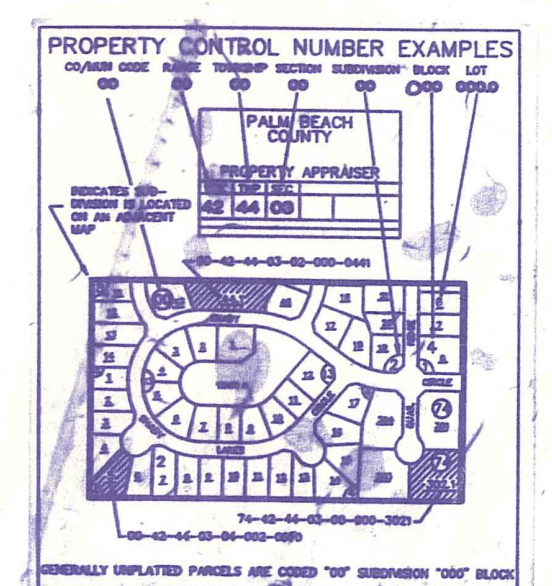

PALM BEACH COUNTY

PROPERTY APPRAISER			
RGE	TWP	SEC	AERIAL
41	44	17	N055+60
SCALE 1" = 200'			
DRAWN BY: S. M. Adams			
UPDATED: 4/8/94			