

INDIAN TRAIL VILLAS PL 2
CODED 72-41-43-14-07

INDIAN TRAIL GOLF COURSE
CODED
72-41-43-14-00-000-5000

Palm Beach County (County) makes no representation or warrants whatsoever on the attached / enclosed information reflected herein pertaining to easements, rights-of-way, setback lines, reservations, agreements, and other similar matters. The information provided herein should not be relied upon by the requesting party to confirm the existence / non-existence of facts contained herein.

ALL OF SECTION CODED IN MUNICIPALITY OF ROYAL PALM BEACH (72)

- SE 01 LA MANCHA REPLAT - PT OF BLK A & B PB31P12 1975
- SE 02 TRAILS AT ROYAL PALM BEACH CONDO (88) PB53P25
- NE 03 INDIAN TRAIL ESTATES UNIT I PB45 P122(98)
- NW 04 LANTERN WALK PLAT I (89) PB49P91
- SE 05 LA MANCHA RE PL OF BLKA LT I (89) PB53P25
- NW 06 FAIRWAYS AT ROYAL PALM BEACH (88) PB56P50
- NW 07 ROYAL PINES ESTS (89) PB58P191
- NW 08 STAMFORD AT ROYAL PALM BEACH (89) PB60P101
- NW 09 LANTERN WALK PL 2 (89) PB61P6
- W 1/4 10 WHISPERING PINES (91) PB65P21
- NW 11 PALM BEACH TRACE COND (91)(92)

NOTE:
LA MANCHA
SUB 03 CODED
IN 41-43-14

NOTE:
FTGS IN DEEDS
CONFLICT & WITH
TRAILS AT RPB/PLAT
IN OR3714P183

NOTE:
LA MANCHA IS CODED
DI IN SEC 14-43-14
OR 6105-1581
(24.04)

NOTE:
THE MILLONS P/AST
ADDITION IS CODED IN
SEC 14-43-14

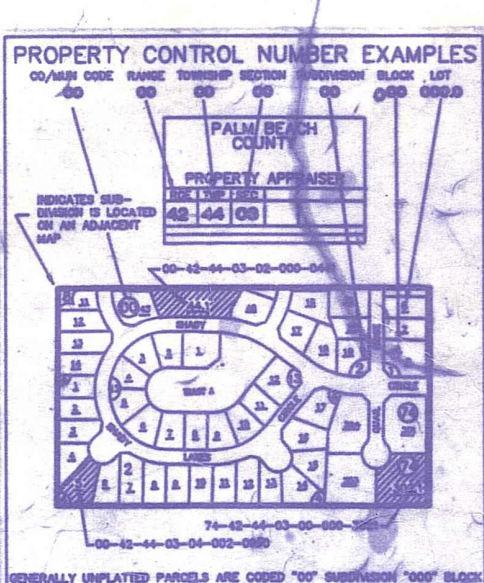

PALM BEACH COUNTY
N-21
PROPERTY APPRAISER

31	32	33	34	35	36	37	38	39	40
1	2	3	4	5	6	7	8	9	10
11	12	13	14	15	16	17	18	19	20
21	22	23	24	25	26	27	28	29	30
31	32	33	34	35	36	37	38	39	40
41	42	43	44	45	46	47	48	49	50
51	52	53	54	55	56	57	58	59	60
61	62	63	64	65	66	67	68	69	70
71	72	73	74	75	76	77	78	79	80
81	82	83	84	85	86	87	88	89	90
91	92	93	94	95	96	97	98	99	100

SEE SEC 41-43-26
TO P.B. CO.
DB 47-457
CONVEYED TO
ROYAL PALM Bch.
COLONY INC.
OR 2320-1990
CORRECTED
OR 2823-1043
(SEE OLD OKECHOBEE RD.
D. O. F. FILE)

SCALE IN FEET

CONTINUE WEST TO
E. 3/4 OF SEC 23
FOR THE SIDE OF OKECHOBEE CREEK

72-41-43-14-04-000-0031
15.45 AC
PT TR 'C' PHASE I

TRACT 'E'
000-0052
15.42 AC

HEATHERWOOD DR
HEATHERWOOD
1134-14

TR 'N'
TR 'M'
13-2
5.25 AC

302
11.27 AC
OR 5860-9168

305
37 AC

304
8.41 AC

707
7.13 AC

701
15.67 AC

705
32 AC

505
3.75 AC

503
1.00 AC

504
1.55 AC

501
3.75 AC

P.E.
OR 6107-6122

FLORIDA POWER & LIGHT CO EASEMENT
P.E. OR 6107-6122
20-11
30.5 AC

FLORIDA POWER & LIGHT CO EASEMENT
P.E. OR 6105-1581
20-11
30.5 AC

500
5.65 AC

OR 6105-1581
FOR 219

OR 6105-1581
FOR 219

OR 6105-1581
FOR 219